

# WI-FI MAINTENANCE AND TROUBLESHOOTING

## CLEARING ROUTER SETTINGS

If you purchase a new Wi-Fi router or change the security settings on your existing router, the router settings in the Home Comfort Control need to be cleared so the new Wi-Fi router settings can be entered. To do this, enter the setup menu as described in the Setup Menu section on pages 34-37. Change the setting for WiFi Disconnect and Clear Settings to Yes and then press **[DONE]**. This will remove all the previous Wi-Fi settings. Refer to the Wi-Fi Quick Start Guide for instructions on connecting the Home Comfort Control to your Wi-Fi network.

## REMOVING THE HOME COMFORT CONTROL FROM A my.aprilaire.com ACCOUNT

The Home Comfort Control can only be registered to one web and mobile app account. If you need to remove the Home Comfort Control from an existing account so it can be registered to a new account, it can be done at the Home Comfort Control. This may need to be done for instance if you have purchased a home with the Home Comfort Control and need to remove the Home Comfort Control from the previous owner's account and register it to your account. To do this, enter the setup menu as described in the following section. Change the setting for Unregister the Thermostat to Yes and then press **[DONE]**. This will remove the Home Comfort Control from any account that it is currently registered to. Refer to the Wi-Fi Quick Start Guide for instructions on registering the Home Comfort Control to a new web and mobile app account.

## SETUP MENU

### HOW TO ENTER THE SETUP MENU TO CHANGE SETTINGS

Press **[MENU]** to enter the main menu.

Press **[SETUP]** to enter the setup menu.

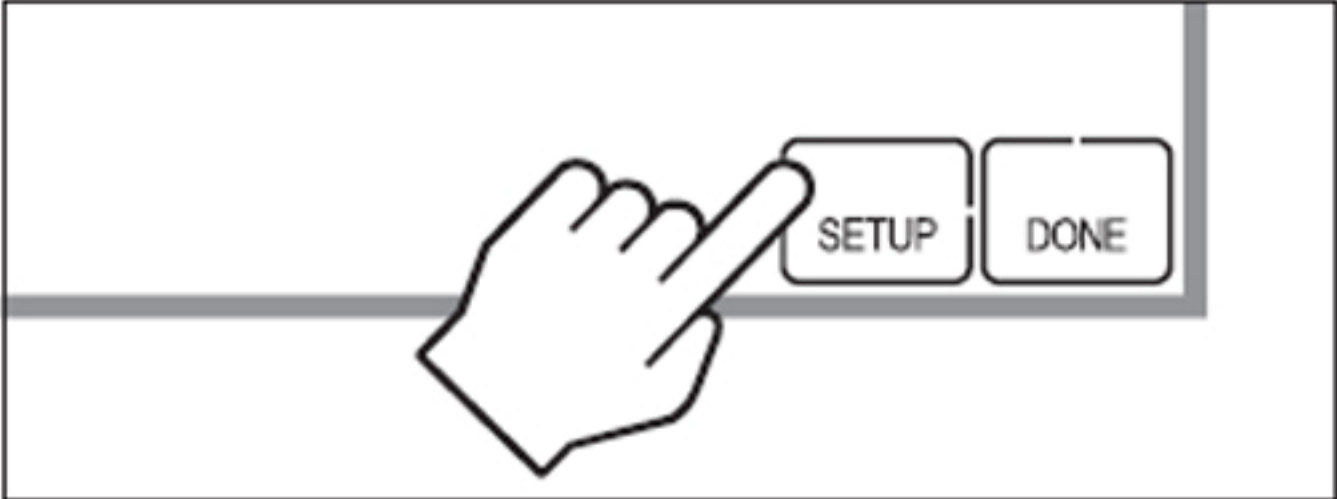

Press **[Next]** or **[Back]** to page through the settings (the setting is displayed in the message center).

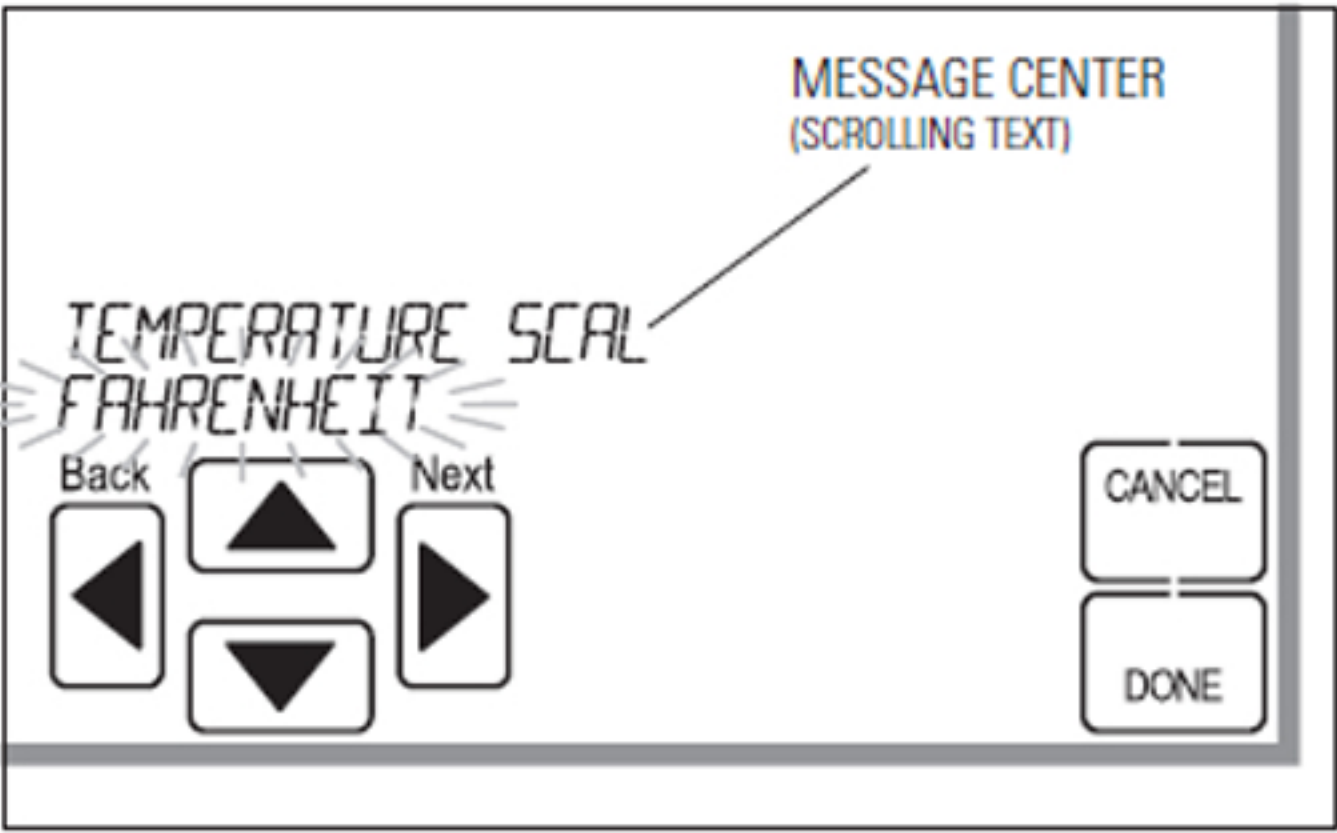

Press ▲ or ▼ to adjust the setting. (Selected option flashes.)

Press **[DONE]** to save and exit, or **[CANCEL]** to exit without saving.

The Home Comfort Control will discard changes and exit if nothing is pressed within 60 seconds.

## USER SYSTEM SETTINGS TABLE

The following table is the list of the settings and their details. Default settings are shown in **bold**.

| User system setting                | Description  | Factory default setting (bold) and setting range |
|------------------------------------|--|--|
| Backlight Intensity                | Set the active backlight intensity. <b>Note:</b> The minimum setting is 40% when Constant Backlight is enabled.  | <b>100 Percent</b><br>0 to 100 Percent           |
| WiFi Disconnect and Clear Settings | Disconnects the Home Comfort Control from the router and clears the Wi-Fi settings. Use this to set the thermostat back to provisioning mode so it can be connected to a new Wi-Fi router.   | <b>No</b><br>Yes                                 |
| Turn Off WiFi Radio                | Use to turn off the Wi-Fi radio. Wi-Fi settings will be maintained.  | <b>No</b><br>Yes                                 |
| Unregister the Thermostat          | Unregisters the thermostat from an Aprilaire account. Use this when the Home Comfort Control needs to be registered to a new Aprilaire account. For instance, if you have purchased a home with the thermostat already installed, this setting would allow you to clear the previous registration so that you can register the thermostat to your account. | <b>No</b><br>Yes                                 |